

## Basic Operation Guide

### Quick Print

#### Services

##### Print

Lets you select and print a desired image.



##### Print All Images

Prints all the images on a memory card.



#### Supported Data Formats

- JPEG (Exif 2.2.1 Baseline)
- TIFF (RGB uncompressed)
- BMP (24-bit Windows)
- Image size: 6,400 x 4,800 pixels max.

#### Supported Memory Cards

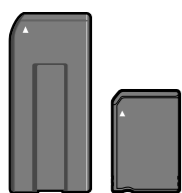

"Memory Stick" Standard/  
"Memory Stick PRO"/  
"Memory Stick Duo"  
compatible



xD-Picture Card



SD Card/  
MultiMediaCard



CompactFlash card  
Microdrive

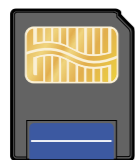

SmartMedia card

#### Caution

Before using a memory card, be sure to create a backup copy of its contents. Sony assumes no liability for lost or damaged data.

## Printing

**1** Touch the screen.

**2** Select your language.\*

**3** Insert your memory card into the slot on the front of the printer.

**4** Select "Print."



**5** Touch the image you want to print.



**6** Touch **+** or **-** to set the number of prints.

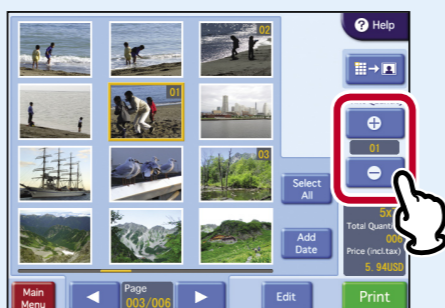

**7** When you finish setting, touch **Print**.

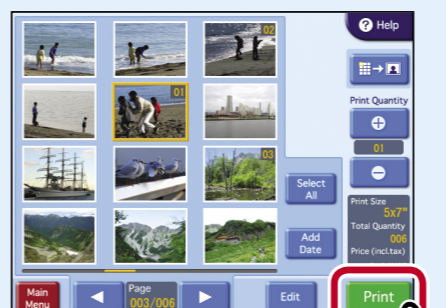

**8** After verifying the number of prints and the price, touch **Print Start**.



**9** Ask the store clerk to enter the password.\*

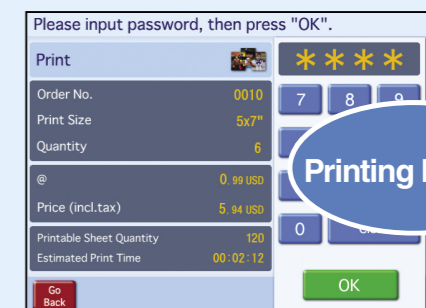

Do not remove your memory card until a message appears asking you to do so.

\*This may not be necessary in some cases.

Make sure not to forget your prints or memory card.

## Printing All Images

**1** Touch the screen.

**2** Select your language.\*

**3** Insert your memory card into the slot on the front of the printer.

**4** Select "Print All Images."



**5** After verifying the number of prints and the price, touch **Print Start**.



**6** Ask the store clerk to enter the password.\*

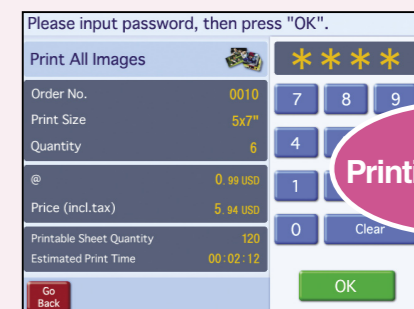

Do not remove your memory card until a message appears asking you to do so.

\*This may not be necessary in some cases.

Make sure not to forget your prints or memory card.

### Maintenance Guide — For Store Clerks —

#### Precautions

- Immediately after printing, the thermal head inside the unit will be hot. When loading a cartridge, do not insert your hand into the ribbon cartridge access opening, to prevent the risk of burns.
- Always use a designated print pack.
- Be sure to replace both the ribbon cartridge and the paper roll as a set.
- Do not touch the printing surface of the paper roll or the ink on the ribbon cartridge. Fingerprints and other pollutants can lead to reduced print quality.

#### Replacing the Ribbon Cartridge

1 Open the side door.

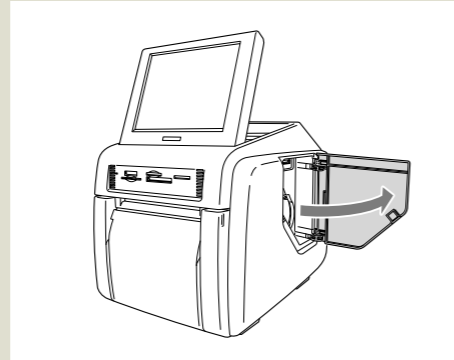

2 Remove the ribbon cartridge.

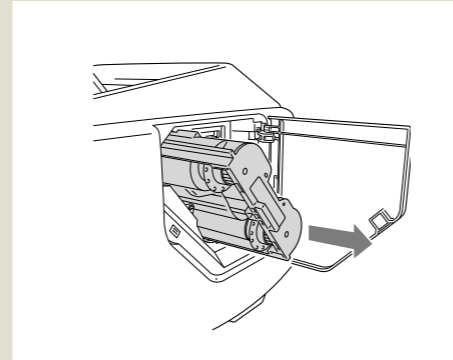

3 Insert the new ribbon cartridge.

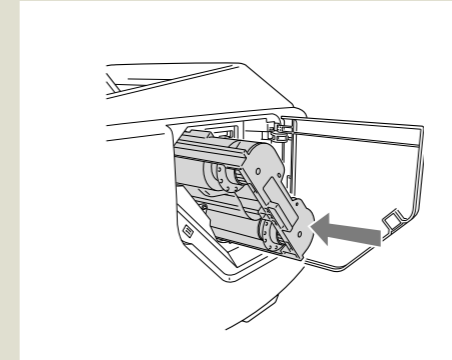

4 Close the side door.

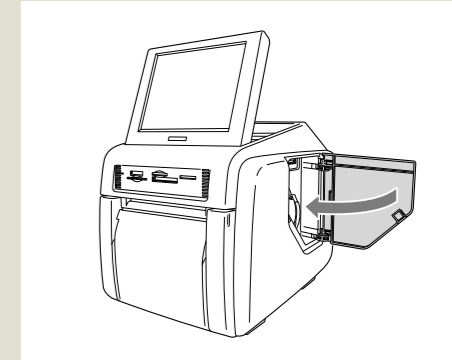

#### Replacing the Paper Roll

1 Open the front door.

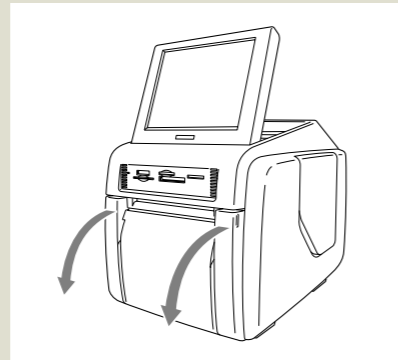

2 Press the paper holder release button, and remove the paper holder.

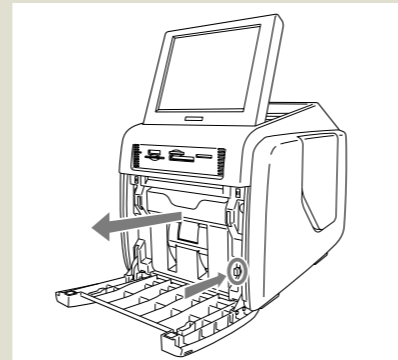

3 Open the paper holder completely by pressing the button at the top.

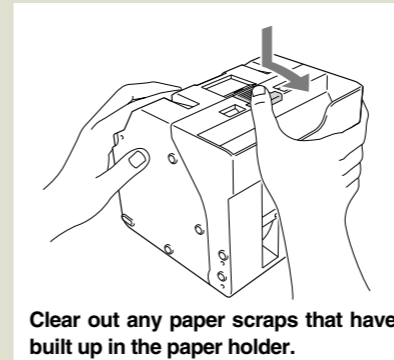

4 Remove the paper roll from the paper holder.

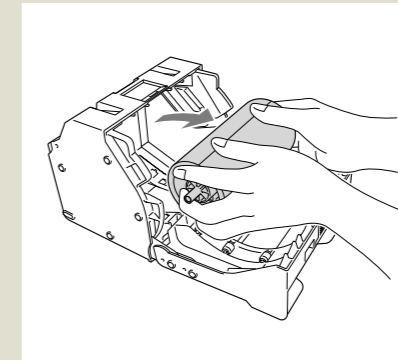

5 Pull the paper core out of the old paper roll.

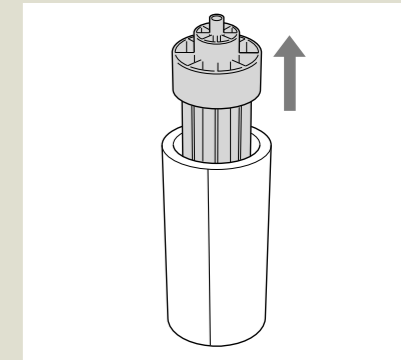

6 Insert the paper core into the new paper roll.

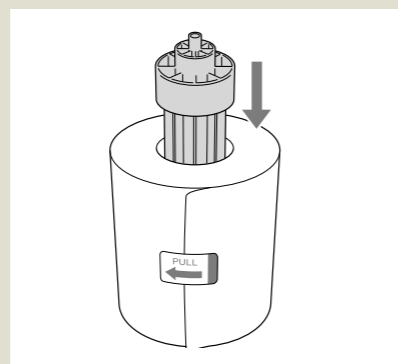

7 Insert the paper roll into the paper holder with the arrow on the label pointing inward, and then remove the label.

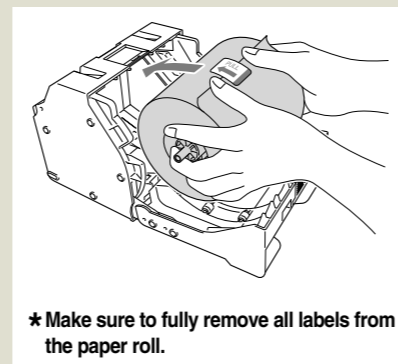

8 Close the paper holder.

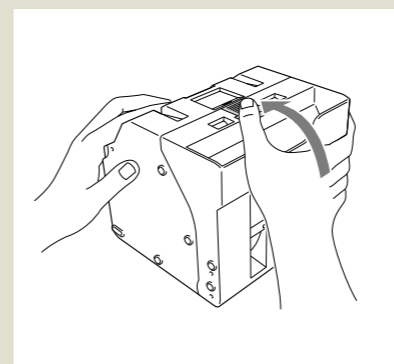

9 Insert the paper holder into the printer.

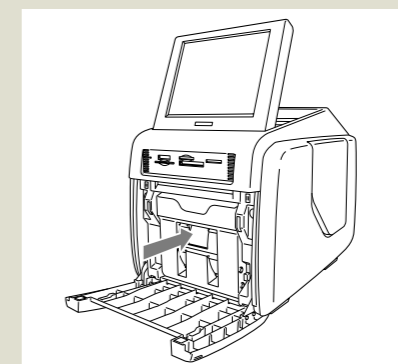

10 Close the front door.

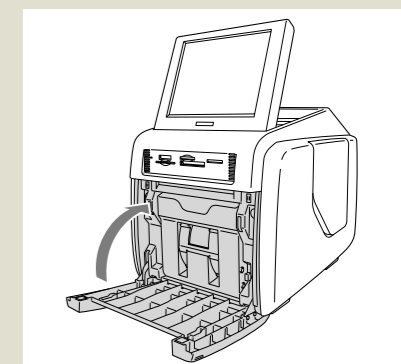

# 

Symptom	Cause/Remedy
<b>Image data cannot be read.</b>	<p><b>A mounted memory card does not contain any data.</b> →Insert a memory card that contains image data.</p> <p><b>Data has been recorded on a memory card in a format that the unit does not recognize.</b> → Be sure to store image data in a format that the unit can recognize.</p> <p><b>The memory card may not be properly inserted.</b> →Make sure that the memory card is fully inserted.</p> <p><b>The memory card may not be inserted in the correct direction.</b> →Set the memory card in the direction shown on the operation screen.</p>
<b>Display not on or difficult to see.</b>	<p><b>Depending on the display angle, the display may not be visible or may be difficult to see.</b> →The display angle can be adjusted. Adjust the angle of the display to improve the display appearance.</p>
<b>There is a white margin on the printed image.</b>	<p><b>The print position may not be correct.</b> →Adjust the print position on the administration screen.</p>
<b>Paper roll was loaded, but “no paper” message appears.</b>	<p><b>Paper roll may not have been loaded correctly.</b> →Ensure that paper roll is loaded correctly.</p>
<b>Ribbon cartridge was loaded, but “no ribbon cartridge” message appears.</b>	<p><b>Ribbon cartridge may not have been loaded correctly.</b> →Ensure that ribbon cartridge is loaded correctly.</p>
<b>Out of paper message appears, but there is still paper in the unit.</b>	<p><b>This is not a defect. Some spare paper will be left over.</b> →Remove the leftover paper and load a new ribbon cartridge and paper roll.</p>
<b>Power does not switch on.</b>	<p><b>The power cord may not be connected.</b> →Make sure that the power cord is connected.</p> <p><b>The on/standby button may not have been pressed correctly.</b> →Make sure that the on/standby button has been fully depressed.</p>
<b>The unit does not switch to standby.</b>	<p><b>The unit may still be doing processing.</b> →Wait a few moments for the unit to stop processing.</p> <p><b>An abnormal condition may have caused the unit to stop responding.</b> →Disconnect the power cord from the power outlet. Then reconnect the power cord, and press the on/standby button.</p>
<b>Cannot load paper roll.</b>	<p><b>Are you trying to load 2UPC-C13, C15 while adaptors are mounted in the paper holder?</b> →Remove the adaptors and then load the paper roll.</p>